

## DOMAINE DAVER

### SCCV CAMPAGNE DAVER

Allée Des PLATANES - 83000 TOULON

### PLANS DE VENTE

- 10/01/2023 -

**LOT Villa 10 TMA - Garage Intégré - Parking P.10**

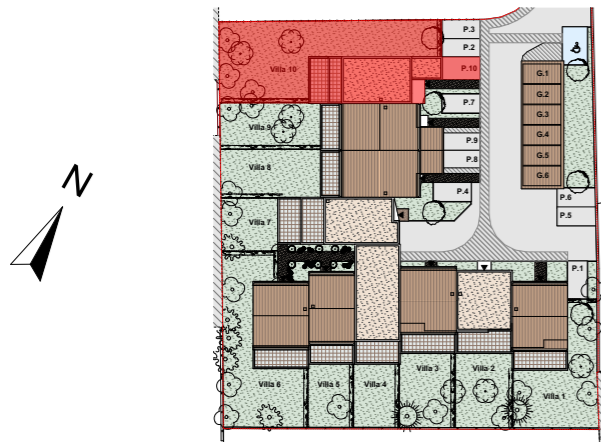

	Pièces	Surfaces m <sup>2</sup>
RDC	Séjour/Cuisine	37,17
	Entrée <small>Compris Rangement</small>	8,26
	WC	1,32
	Rangement	1,38
R+1	Chambre 1	11,12
	Chambre 2	11,73
	Chambre 3	9,69
	Salle de Bains 2	3,61
	WC 2	1,31
	Dégagement	3,90
<b>TOTAL</b>		<b>89,49 m<sup>2</sup></b>
	Garage	14,60
	Terrasse 1	14,36
	Terrasse 2	9,30
	Jardin Privatif	213,21

### Plan De Masse - 1:200

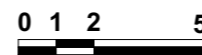
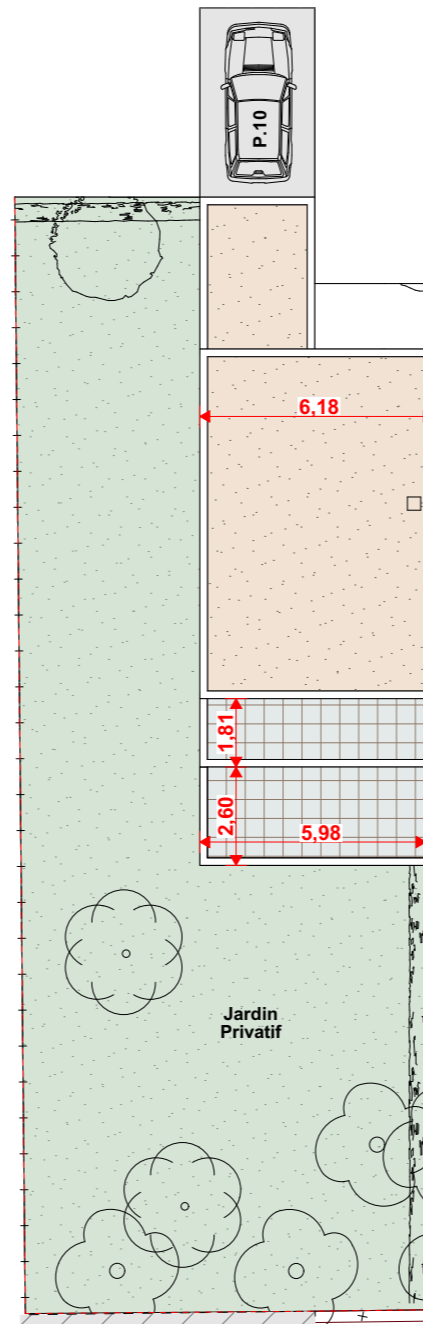

**Façade OUEST**





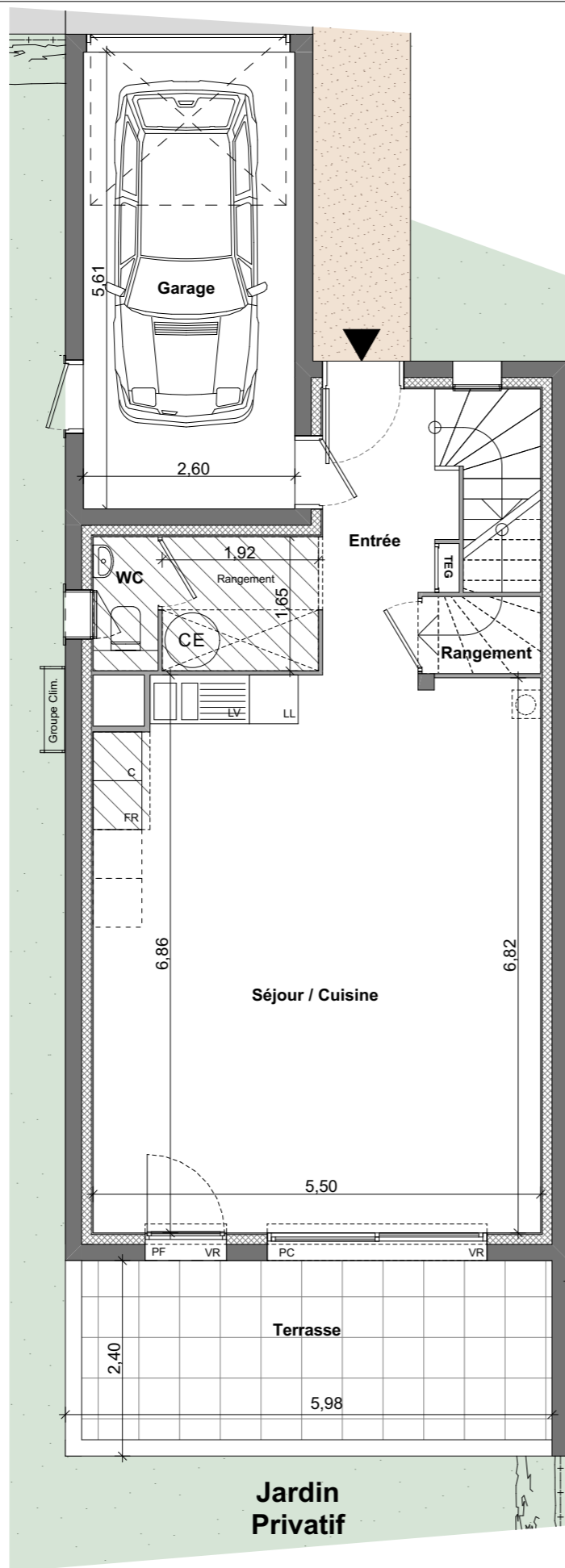

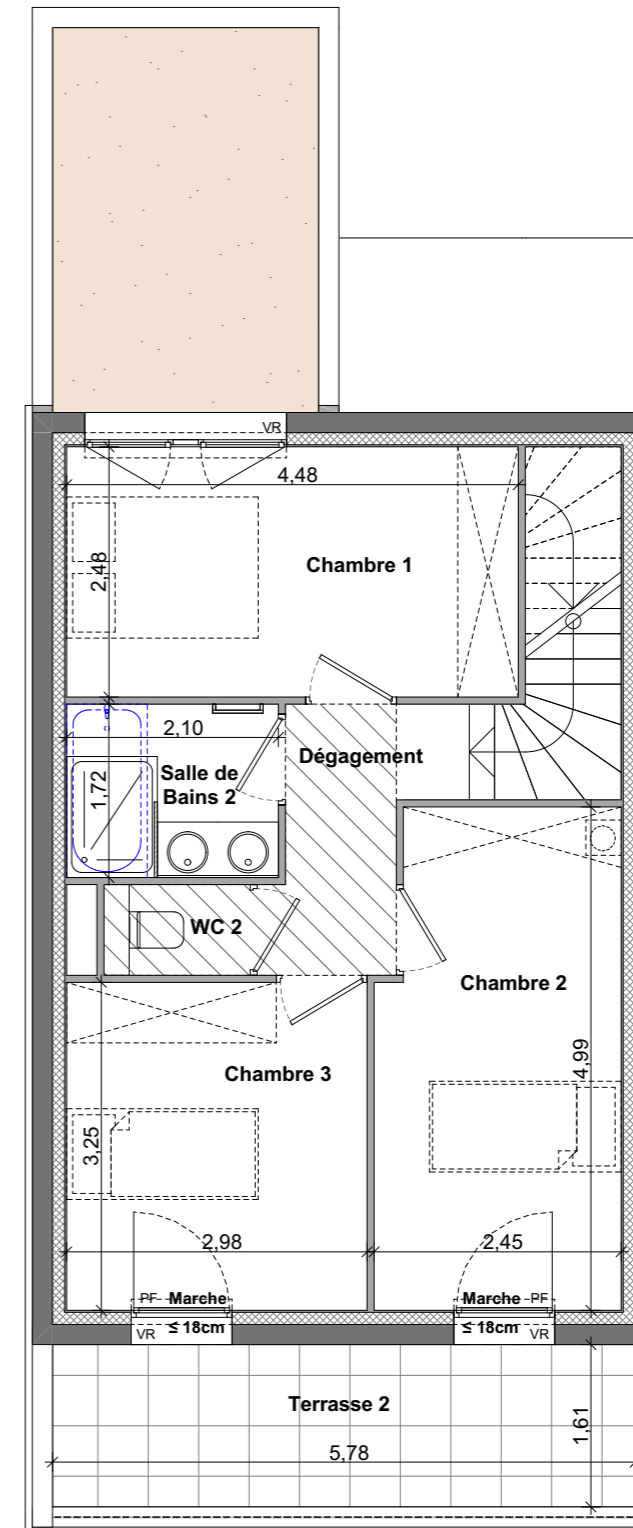

**Façade EST**

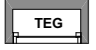

**Plan Rez de Chaussée - 1:75**



**Plan Niveau 1 - 1:75**

-  SOFFITE FAUX PLAFOND Ht ≥ 2.10m.
-  TABLEAU ELECTRIQUE
-  BALLON d'EAU CHAUDE
-  Porte Fenêtre
-  Baie Coulissante
-  Fenêtre
-  Volets Roulants

